

**➔ Application**

- LED omnidirectional elevated taxiway edge lights for airports and heliports

**➔ Accordance with**

- ICAO Annex 14, Vol.1
- FAA AC 150/5345-46

**➔ Description/Properties**

- small dimensions and low height
- long service life due to robust construction (aluminum alloys, stainless steel, glass)
- attaches to breakable coupling or AL tube Ø 60 mm
- exactly meets the conditions of intensity regulation according to FAA EB 67D in the whole range of 2.8–6.6A
- easy reparability ensures efficient maintenance, significant reduction of operating costs and protects the environment
- the light can be easily and quickly disassembled into several basic components that can be ordered as affordable spare parts
- the light is equipped with a pressure equalizer that prevents the accumulation and condensation of water inside the light
- integrated blue reflective surface increases the safety of air traffic in the event of power failures and facilitates maintenance (eg locating a non-illuminated light)
- is fully compatible with standard serial wiring
- when replaced with halogen lights, it does not require replacement of the transformer and the constant current regulator

**➔ Mechanical parameters**

- weight 1,3 kg
- dimensions: height 130 mm, diameter 147 mm
- standard length of supply cable 350 mm
- standard connector  
L-823 Type II, Class B, Style 5

**➔ Elektrical parameters**

- input current 2,8–6,6 A (6,6 A version)
- input current 0,9–2,2 A (2,2 A version)
- max. power consumption 7 VA (6,6 and 2,2 A version)

**➔ Resistance to**

- temperature -55 ÷ +55 °C and thermal shock
- salt fog, solar and UV radiation
- dust, humidity, snow, ice, and water IP67
- vibrations 20 ÷ 2 000 Hz with acceleration 2 G

**➔ Source of light**

- high power LEDs, lifespan >100 000 hrs. of standard operation

**➔ Power-ups**

- standard airports isolation transformer 6,6/6,6 A power min. 15 VA for 6,6 A version
- standard airports isolation transformer 6,6/2,2 A power min. 15 VA for 2,2 A version

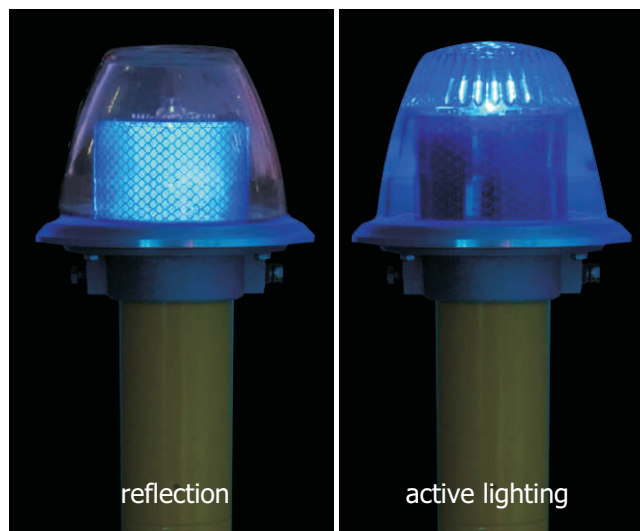

chapter:

5.3.4

TLE23



### Construction / spare parts

- 493-719 diopter with support ring
- 403-113 light head gasket
- 803-675 module TWE-01
- 803-677A module TWT-01.6 pro 6,6 A
- 803-677B module TWT-01.2 pro 2,2 A
- 421-504 reflex cylinder
- 493-433 lower flange
- 196-505 pressure equalizer
- 190-802 bushing
- 189-676B input cable
- 500-420N ground screw
- 500-416N locking screw

See figure for other order codes

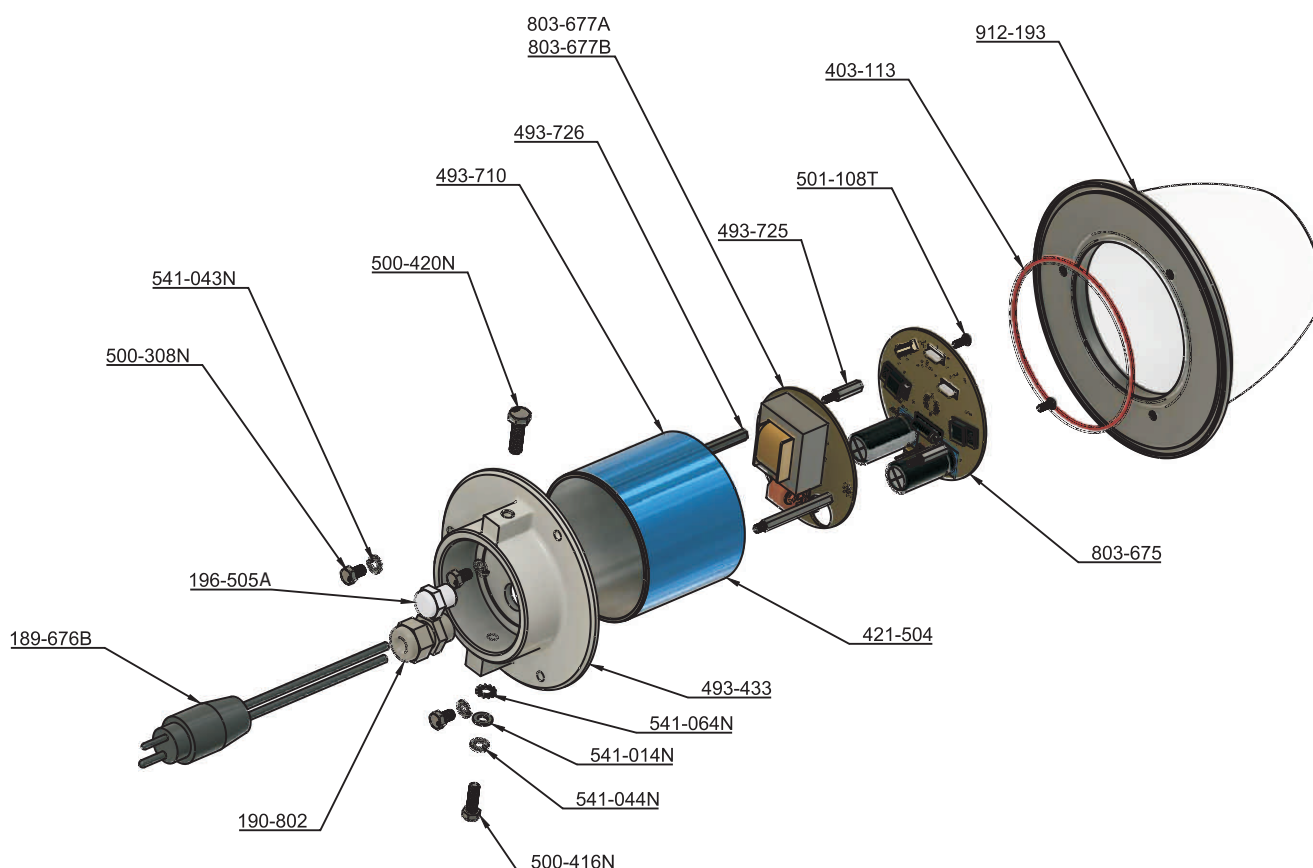

### Ordering codes

TLE230-TWY-B-S6-C9

#### light fixture group

0 - omnidirectional

#### light fixture function

TWY taxiway edge light

#### beam color

B - blue

#### power-ups

S6 - 6,6 A airport series circuit

S2 - 2,2 A airport series circuit

#### other specifications

\* code for „other specification“ must be written in alphabetical order

PORT - mobile version (including base plate with handles included)

C9 - atypical power ups connection (atypical connectors)

### Ordering code examples:

TLE230-TWY-B-S6

taxiway edge lights, blue, 6,6 A airport series circuit

TLE230-TWY-B-S2

taxiway edge lights, blue, 2,2 A airport series circuit